

TRAFFIC SWINGING SINGLE LEAF DOORS WITH GRAVITY HINGES

(TSD GR)

ALL PRICES IN US DOLLARS, 2 MM THICK DOOR FRAME INCLUDED, VAT NOT INCLUDED

26.03.2025

- PH Insulation's traffic swinging doors are designed to separate premises with intensive traffic of personnel. The factory-made doors are ready for installation in supermarkets, restaurants, hospitals, food production facilities, etc. Doors can be equipped with oval windows of 200x500 or 300x580 mm.
- PH Insulation's doors with gravity hinges are set up faster with less adjustment compared to fixating hinges, need less maintenance and provide for increased dimensions of light opening.
- PH Insulation's traffic doors are not meant to completely seal the opening due to technical clearance gaps along the perimeter between the frame and the door leaf.

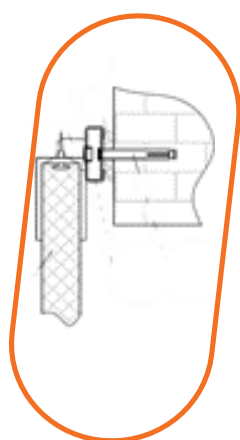

OVERHEAD FRAME

INSTALLATION OPENING, HEIGHT, MM	INSTALLATION OPENING, WIDTH, MM						
	700	800	900	1000	1100	1200	1300
1800	448	491	500	514	523	543	557
1900	453	498	507	521	531	550	565
2000	458	504	514	528	538	558	573
2100	462	511	521	535	545	566	582
2200	468	519	528	544	554	575	591
2300	473	526	536	551	562	583	599
2400	479	534	544	560	571	593	609
2500	488	543	553	570	581	603	620
2600	499	556	567	584	595	618	636
2700	505	564	575	592	604	627	645
2800	511	572	583	601	613	637	655
2900	519	583	594	612	624	649	667
3000	525	593	605	623	635	660	679
3100	532	602	614	632	645	671	690
3200	540	611	623	643	655	682	701
3300	547	620	633	653	666	692	712

RAL 9003

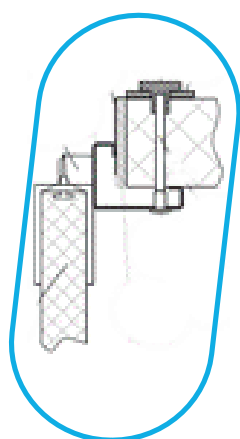

ANGULAR FRAME

INSTALLATION OPENING, HEIGHT, MM	INSTALLATION OPENING, WIDTH, MM						
	700	800	900	1000	1100	1200	1300
1800	495	539	549	564	576	598	614
1900	501	547	557	573	586	608	624
2000	506	555	565	581	594	616	633
2100	513	564	574	591	604	627	644
2200	520	573	583	600	614	637	654
2300	530	585	596	613	627	651	669
2400	536	593	604	621	635	660	678
2500	547	603	615	633	647	672	691
2600	557	616	628	646	661	687	706
2700	565	626	638	657	672	698	718
2800	573	636	648	668	683	709	729
2900	585	651	663	683	699	726	747
3000	594	663	676	696	712	740	761
3100	600	672	685	706	722	750	772
3200	610	684	697	718	735	764	786
3300	616	693	706	728	745	774	796

RAL 9003

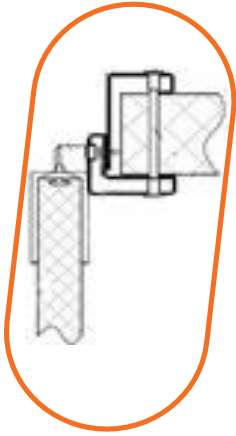
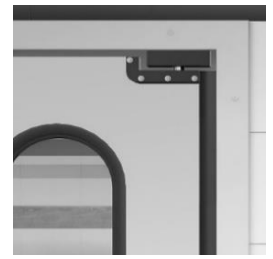

OVERLAPPING FRAME

INSTALLATION OPENING, HEIGHT, MM	INSTALLATION OPENING, WIDTH, MM						
	700	800	900	1000	1100	1200	1300
1800	561	608	620	639	652	678	697
1900	569	619	631	650	664	689	709
2000	580	632	644	663	678	704	724
2100	588	642	655	674	689	716	737
2200	599	655	668	689	704	731	752
2300	610	669	682	703	718	747	768
2400	624	685	699	720	736	765	787
2500	636	698	712	734	750	779	802
2600	648	712	726	749	765	795	819
2700	661	727	742	764	781	812	836
2800	670	739	754	777	794	826	850
2900	686	757	772	796	814	846	871
3000	700	775	791	815	833	866	891
3100	709	787	803	828	846	880	905
3200	721	801	817	843	861	896	922
3300	731	813	830	855	874	909	936

RAL 9003

OUR DOORS ARE AVAILABLE IN CUSTOM SIZES TO INSURE BEST COMMERCIAL APPLICATION

TRAFFIC SWINGING DOUBLE LEAF DOORS WITH GRAVITY HINGES

ALL PRICES IN US DOLLARS, 2 MM THICK DOOR FRAME INCLUDED, VAT NOT INCLUDED

(TDD GR)

26.03.2025

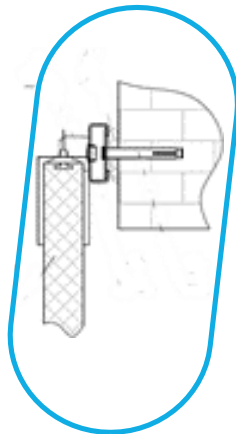

OVERHEAD FRAME

INSTALLATION OPENING, HEIGHT, MM	INSTALLATION OPENING, WIDTH, MM				
	1000	1100	1200	1300	1400
1800	793	797	809	813	881
1900	801	805	818	822	893
2000	811	815	828	832	907
2100	819	823	836	840	919
2200	827	831	844	848	932
2300	837	842	855	859	946
2400	847	852	867	872	963
2500	856	862	877	882	977
2600	873	878	894	899	998
2700				910	1013
2800				921	1028
2900				933	1043
3000				946	1060
3100				958	1079
3200				971	1096
3300				984	1112

RAL 9003

OVERHEAD FRAME

	INSTALLATION OPENING, HEIGHT, MM	INSTALLATION OPENING, WIDTH, MM				
		1500	1600	1700	1800	1900
RAL 9003	1800	885	889	892	896	902
	1900	897	901	905	909	915
	2000	911	915	919	923	930
	2100	924	928	932	936	943
	2200	936	940	945	949	956
	2300	951	955	960	964	971
	2400	968	972	977	982	989
	2500	982	987	992	997	1004
	2600	1003	1008	1013	1019	1026
	2700	1018	1024	1029	1034	1042
	2800	1034	1039	1044	1050	1057
	2900	1049	1055	1060	1066	1074
	3000	1066	1072	1078	1083	1092
	3100	1085	1091	1097	1103	1111
	3200	1102	1108	1114	1120	1128
	3300	1119	1125	1131	1137	1146

OVERHEAD FRAME

	INSTALLATION OPENING, HEIGHT, MM	INSTALLATION OPENING, WIDTH, MM						
		2 000	2 100	2 200	2 300	2 400	2 500	2 600
RAL 9003	1800	906	910	913	917	923	927	931
	1900	919	923	927	931	937	941	945
	2000	934	938	942	946	952	957	961
	2100	947	951	956	960	966	971	975
	2200	960	965	969	974	980	985	989
	2300	976	981	985	990	997	1001	1006
	2400	994	999	1003	1008	1015	1020	1025
	2500	1009	1014	1019	1024	1031	1036	1041
	2600	1031	1036	1041	1047	1054	1059	1064
	2700	1047	1052	1058	1063	1070	1076	1081
	2800	1063	1068	1074	1079	1087	1093	1098
	2900	1080	1085	1091	1096	1104	1110	1116
	3000	1097	1103	1109	1115	1123	1129	1135
	3100	1117	1123	1129	1135	1143	1149	1155
	3200	1135	1141	1147	1153	1162	1168	1174
	3300	1153	1159	1165	1172	1180	1187	1193

ANGULAR FRAME

	INSTALLATION OPENING, HEIGHT, MM	INSTALLATION OPENING, WIDTH, MM				
		1000	1100	1200	1300	1400
RAL 9003	1800	845	852	864	868	939
	1900	855	862	875	879	954
	2000	864	871	884	888	967
	2100	875	882	895	900	983
	2200	886	894	907	912	999
	2300	900	908	921	926	1017
	2400	911	919	935	940	1034
	2500	923	930	947	952	1051
	2600	941	949	965	970	1073
	2700				984	1091
	2800				998	1109
	2900				1015	1130
	3000				1029	1148
	3100				1041	1166
	3200				1053	1182
	3300				1065	1198

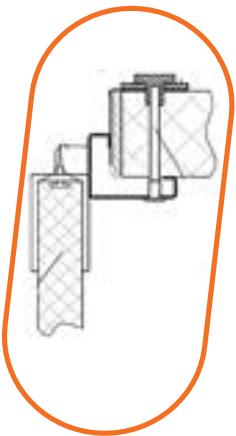

ANGULAR FRAME

	INSTALLATION OPENING, HEIGHT, MM	INSTALLATION OPENING, WIDTH, MM				
		1500	1600	1700	1800	1900
RAL 9003	1800	943	948	952	956	962
	1900	958	963	967	971	978
	2000	972	976	980	985	992
	2100	988	992	997	1001	1008
	2200	1004	1008	1013	1018	1025
	2300	1022	1027	1032	1037	1044
	2400	1040	1045	1050	1055	1062
	2500	1056	1061	1067	1072	1080
	2600	1079	1084	1090	1095	1103
	2700	1097	1103	1108	1114	1122
	2800	1115	1121	1127	1133	1141
	2900	1136	1142	1148	1154	1162
	3000	1154	1160	1167	1173	1181
	3100	1172	1179	1185	1192	1201
	3200	1188	1195	1201	1208	1217
	3300	1204	1211	1218	1225	1234

ANGULAR FRAME

	INSTALLATION OPENING, HEIGHT, MM	INSTALLATION OPENING, WIDTH, MM						
		2 000	2 100	2 200	2 300	2 400	2 500	2 600
RAL 9003	1800	969	973	977	981	987	994	998
	1900	984	989	993	997	1004	1011	1015
	2000	998	1003	1007	1012	1019	1025	1030
	2100	1015	1020	1025	1029	1036	1043	1048
	2200	1032	1037	1042	1047	1054	1061	1066
	2300	1051	1056	1062	1067	1074	1081	1086
	2400	1070	1075	1080	1086	1093	1101	1106
	2500	1087	1093	1098	1103	1111	1119	1124
	2600	1111	1117	1122	1128	1135	1143	1149
	2700	1130	1136	1141	1147	1155	1163	1169
	2800	1149	1155	1161	1167	1175	1183	1189
	2900	1171	1177	1183	1189	1198	1206	1212
	3000	1190	1197	1203	1209	1218	1226	1233
	3100	1209	1216	1222	1229	1237	1246	1253
	3200	1226	1233	1239	1246	1255	1264	1270
	3300	1243	1250	1256	1263	1272	1282	1288

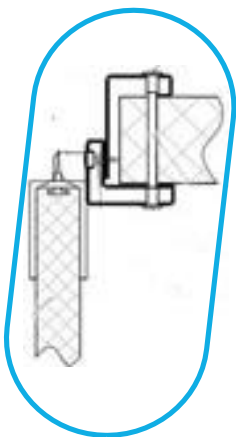

OVERLAPPING FRAME

	INSTALLATION OPENING, HEIGHT, MM	INSTALLATION OPENING, WIDTH, MM				
		1000	1100	1200	1300	1400
RAL 9003	1800	919	925	940	945	1018
	1900	930	937	952	957	1035
	2000	942	949	964	970	1051
	2100	958	965	980	986	1071
	2200	970	977	992	998	1088
	2300	984	992	1007	1013	1106
	2400	1003	1011	1028	1035	1132
	2500	1015	1023	1041	1048	1150
	2600	1034	1042	1060	1067	1173
	2700				1082	1192
	2800				1097	1211
	2900				1115	1232
	3000				1134	1256
	3100				1150	1277
	3200				1167	1299
3300				1182	1318	

OVERLAPPING FRAME

	INSTALLATION OPENING, HEIGHT, MM	INSTALLATION OPENING, WIDTH, MM				
		1500	1600	1700	1800	1900
RAL 9003	1800	1024	1030	1035	1041	1049
	1900	1040	1046	1052	1057	1066
	2000	1056	1062	1068	1074	1083
	2100	1078	1084	1090	1096	1104
	2200	1094	1100	1106	1113	1121
	2300	1113	1119	1126	1132	1141
	2400	1139	1146	1152	1159	1168
	2500	1157	1164	1171	1177	1186
	2600	1180	1187	1194	1201	1210
	2700	1199	1206	1214	1221	1230
	2800	1218	1226	1233	1240	1250
	2900	1240	1247	1255	1262	1272
	3000	1264	1272	1279	1287	1297
	3100	1285	1293	1301	1309	1319
	3200	1307	1315	1323	1331	1342
	3300	1326	1335	1343	1351	1362

OVERLAPPING FRAME

	INSTALLATION OPENING, HEIGHT, MM	INSTALLATION OPENING, WIDTH, MM						
		2 000	2 100	2 200	2 300	2 400	2 500	2 600
RAL 9003	1800	1055	1061	1066	1072	1080	1087	1092
	1900	1073	1078	1084	1090	1098	1105	1111
	2000	1090	1096	1102	1107	1116	1123	1129
	2100	1112	1118	1124	1130	1139	1146	1152
	2200	1129	1135	1142	1148	1157	1164	1170
	2300	1149	1155	1162	1168	1177	1185	1191
	2400	1176	1183	1189	1196	1205	1213	1220
	2500	1194	1201	1208	1215	1224	1232	1239
	2600	1219	1226	1233	1239	1249	1257	1264
	2700	1239	1246	1253	1260	1269	1278	1285
	2800	1259	1266	1273	1280	1290	1299	1306
	2900	1281	1289	1296	1304	1313	1322	1330
	3000	1306	1314	1322	1330	1340	1349	1356
	3100	1329	1337	1345	1353	1363	1372	1380
	3200	1351	1360	1368	1376	1386	1395	1404
	3300	1372	1380	1388	1396	1407	1416	1425

OUR DOORS ARE AVAILABLE IN CUSTOM SIZES TO INSURE BEST COMMERCIAL APPLICATION

DOOR CATALOGUE CODES

TSD	SWINGING SINGLE LEAF DOORS
TDD	SWINGING DOUBLE LEAF DOORS
RIGHT / LEFT	HINGES ON THE RIGHT / HINGES ON THE LEFT

EXAMPLE OF DOOR CATALOGUE CODE: TSD 800 2000 40 RAL9003/RAL9003 ANG RIGHT

DOOR TYPE	DOORWAY WIDTH	DOORWAY HEIGHT	DOOR THICKNESS	COVERING MATERIAL		FRAME TYPE	HINGES LOCATION
				EXTERIOR METAL	INTERIOR METAL		
TSD	800	2 000	40	RAL9003	RAL9003	ANGULAR	RIGHT

ADDITIONAL OPTIONS FOR TRAFFIC SWINGING DOORS

ITEM	PRICE
TDD FRAME INSTALLATION HARDWARE TO INSULATED SANDWICH PANELS	15
TSD FRAME INSTALLATION HARDWARE TO INSULATED SANDWICH	11
TDD FRAME INSTALLATION HARDWARE TO A BRICK WALL	10
TSD FRAME INSTALLATION HARDWARE TO A BRICK WALL	5
FRAME INSTALLATION HARDWARE FOR STEEL STUD CONSTRUCTION	3
DOOR BLADE MATERIAL: AISI 304, PRICE FOR 1 SQ. M	40
DOOR BLADE MATERIAL: AISI 430, PRICE FOR 1 SQ. M	27
OVERHEAD FRAME AISI 304, PRICE FOR RUNNING METER	26
ANGULAR FRAME AISI 304, PRICE FOR RUNNING METER	42
OVERLAPPING FRAME AISI 304, PRICE FOR RUNNING METER	99
OVERHEAD FRAME AISI 430, PRICE FOR RUNNING METER	15
ANGULAR FRAME AISI 430, PRICE FOR RUNNING METER	24
OVERLAPPING FRAME AISI 430, PRICE FOR RUNNING METER	57
HIDDEN INSTALLATION HARDWARE FOR TSD	54
HIDDEN INSTALLATION HARDWARE FOR TDD	64
HIDDEN INSTALLATION HARDWARE FOR TSD WITH AISI 304 FRAME	74
HIDDEN INSTALLATION HARDWARE FOR TDD WITH AISI 304 FRAME	88
HIDDEN INSTALLATION HARDWARE FOR TSD WITH AISI 430 FRAME	66
HIDDEN INSTALLATION HARDWARE FOR TDD WITH AISI 304 FRAME	78

FACTORY INSTALLED BUMPERS FOR TSD

BUMPER MATERIAL	THICKNESS, MM	PRICE FOR SQ. M	PRICE FOR RUNNING METER	
			BOTTOM 0,25 M	BOTTOM 0,5 M
AISI 304	1,5	133	33	66
AISI 430	1,5	88	22	44
ALUMINIUM CHECKER PLATE	1,5	70	17	35
FLAT HDP PLASTIC	4,0	40	10	20
CURVED HDP PLASTIC	6,0	57	14	29

FACTORY INSTALLED BUMPERS FOR TDD

BUMPER MATERIAL	THICKNESS, MM	PRICE FOR SQ. M	PRICE FOR RUNNING METER	
			BOTTOM 0,25 M	BOTTOM 0,5 M
AISI 304	1,5	139	35	70
AISI 430	1,5	91	23	46
ALUMINIUM CHECKER PLATE	1,5	74	18	37
FLAT HDP PLASTIC	4,0	41	10	20
CURVED HDP PLASTIC	4,0	47	12	23
CURVED HDP PLASTIC	6,0	58	15	29

PACKAGING

ITEM	PRICE
STRETCH-WRAP	INCLUDED IN DOOR PRICE
CARDBOARD PACKAGING	CALCULATED INDIVIDUALLY FOR YOUR ORDER
WOODEN PACKAGING	CALCULATED INDIVIDUALLY FOR YOUR ORDER

